

Acrylic Standees & Components

Intro

Acrylic components such as standees are covered with a protective film to prevent scratches during production and transport.

This film is put on at the factory, but it must be removed by players before assembly. Sometimes it can be unclear to players that there is a protective film on there due to the transparent nature of the film. As the tolerances of acrylic standees and their bases are very small, this can lead to damage and/or cracking of either the standee or the base.

We recommend putting instructions in the rulebook or elsewhere in the box, asking players to remove the film before assembling acrylic standees.



THE GRAPHIC BELOW IS FOR INSPIRATION FOR YOUR OWN INSTRUCTIONS. ALTERNATIVELY, YOU HAVE BODA GAMES' PERMISSION TO COPY AND USE IT AS IS.

Assembly instructions for acrylic components

1

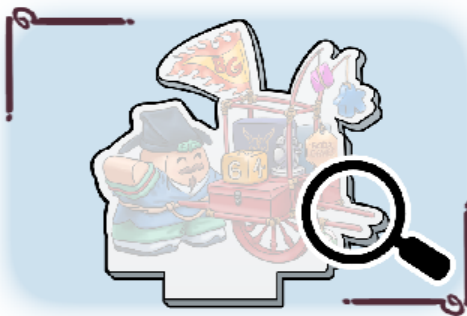

Confirm that there is a protective film on the acrylic. Make sure to check both sides. If yes, remove the protective film before assembling it with other components.

2



Use your fingernail or a piece of tape to catch the protective film, lift it and peel it from the acrylic surface.

3

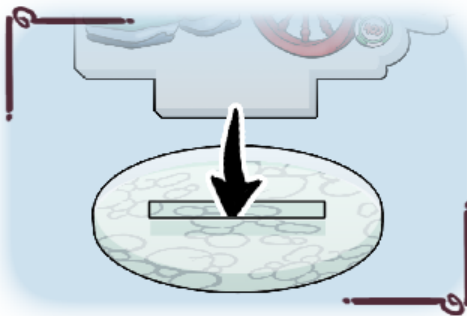

Due to the laser cutting process, acrylic edges may have a slight taper. If the fit feels tight, try inserting the standee from the opposite side or flipping it over.